



Personalized Learning Environments

Architectural Considerations for Supporting Personalized Learning



Primordial Metaphors for Learning

Types of Interaction, Instruction, Study



Watering Hole



Mountain Top



Sandpit



Cave



Campfire



Watering Hole

Exchange ideas and cross pollinate





Mountain Top

Celebrate and sharing your learning





Sandpit

Play, prototype, and experiment





Cave

Private reflection, thought, exploration





Campfire

Share stories, exchange ideas, brainstorm





Organizing Space

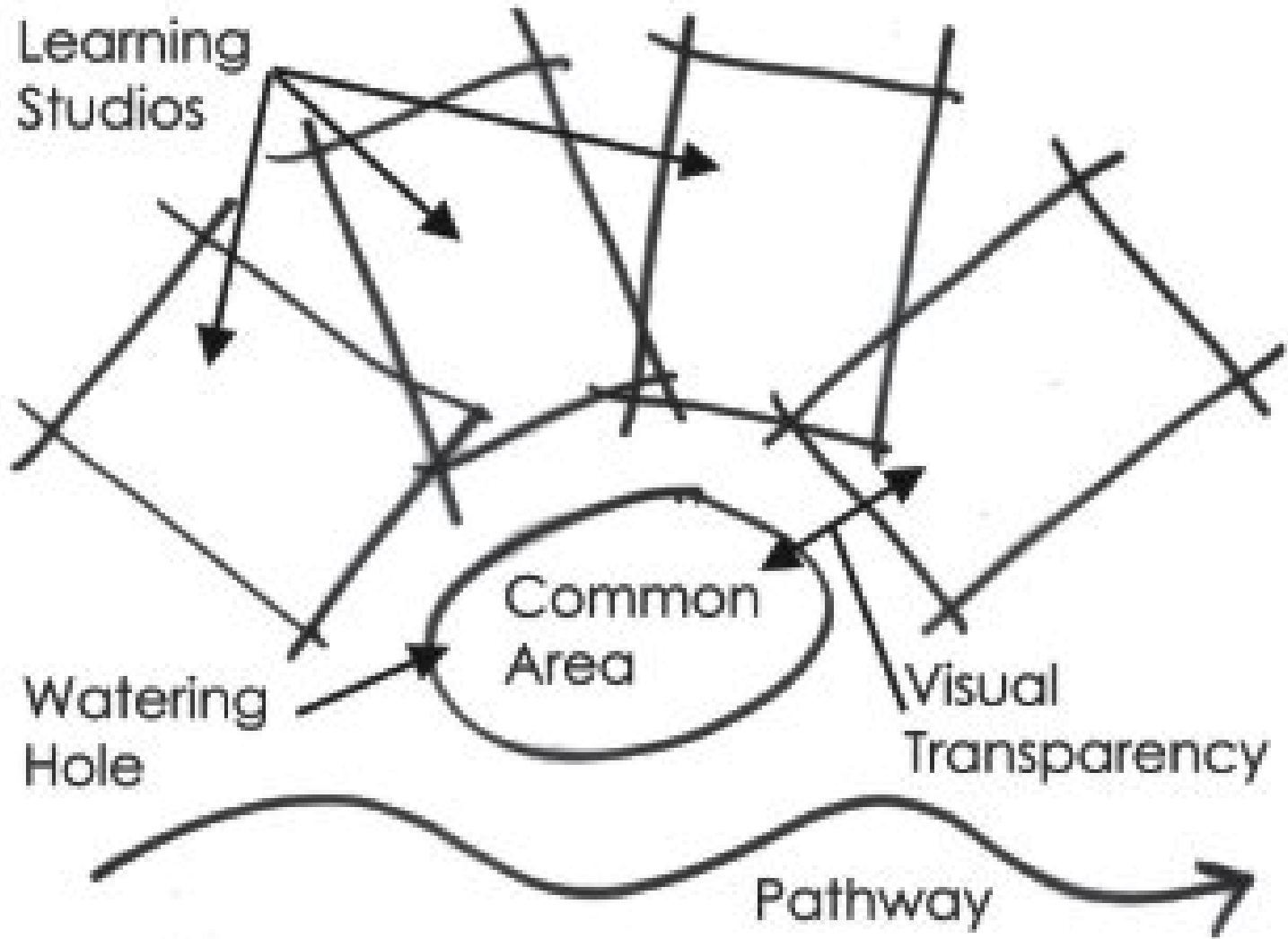



Learning Studios

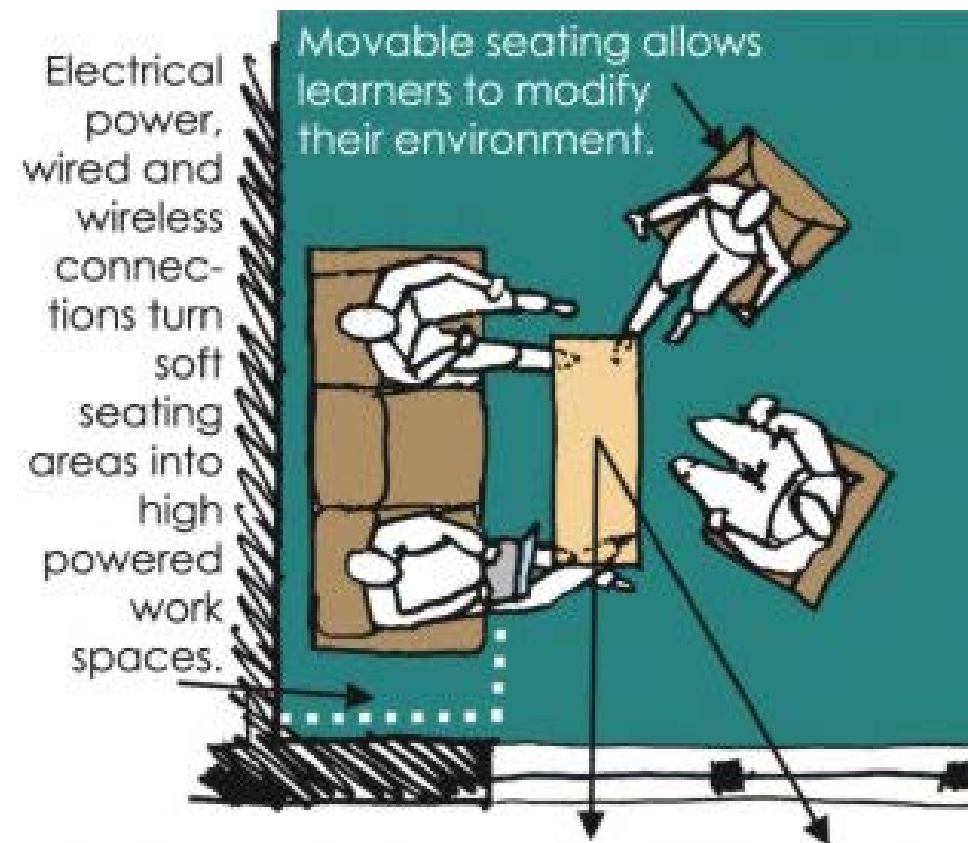
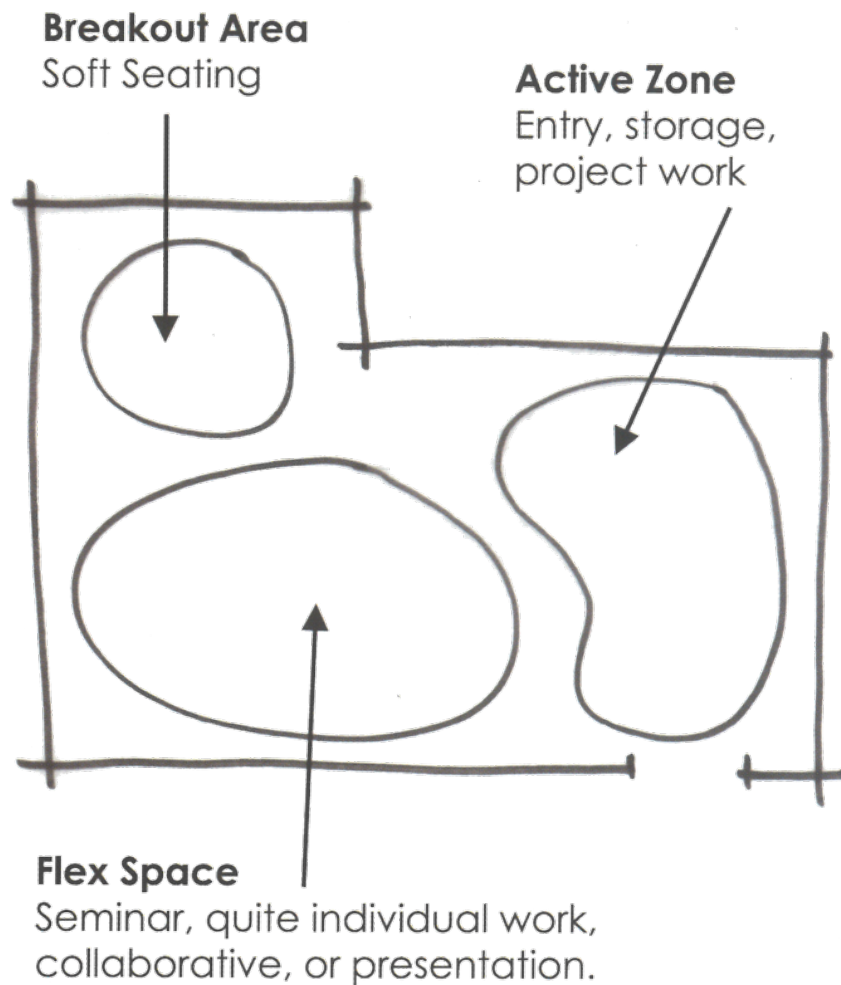

Vistas to the city, community activities or nature foster broad-based rather than narrowly referenced thinking.



Learning Studios

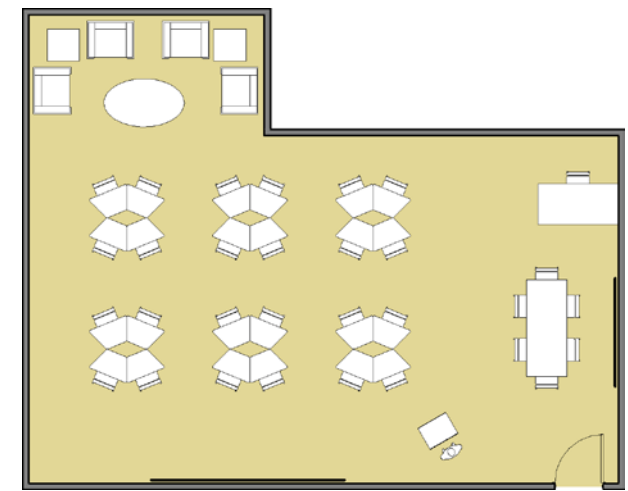
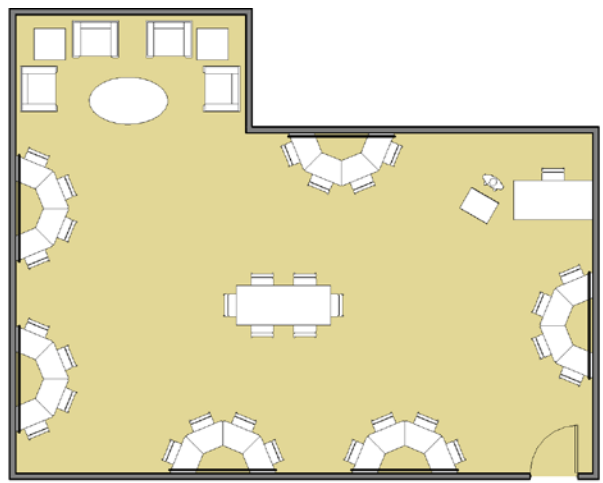
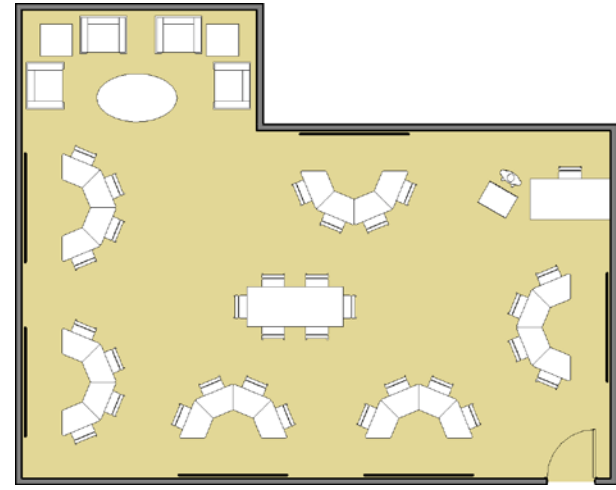
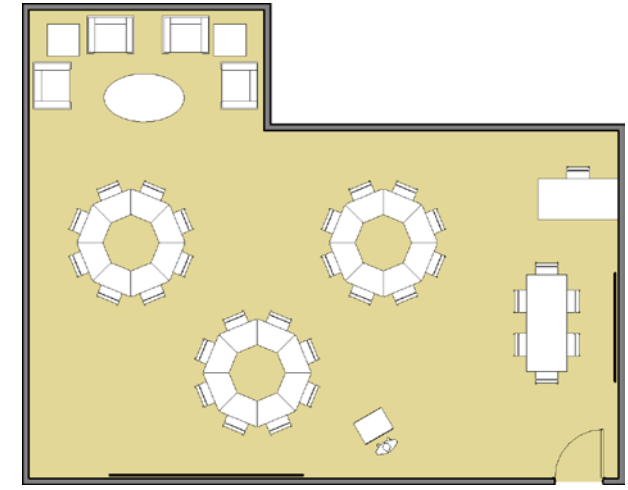
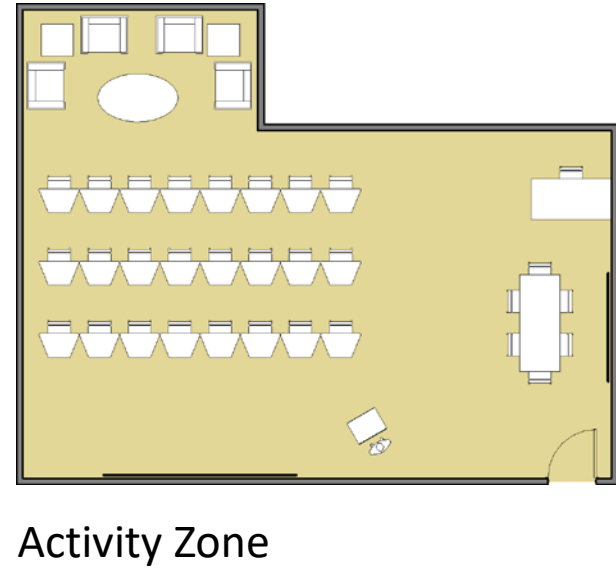
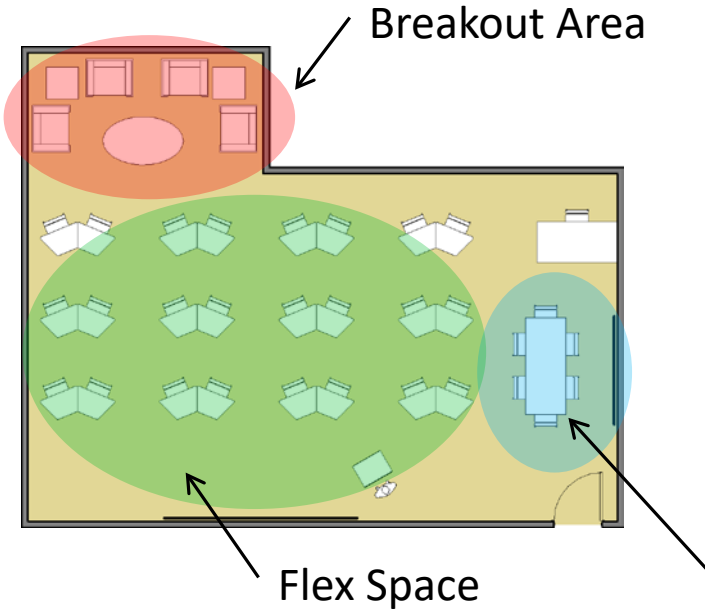

900 SF space – 24 Students – Same Furniture





Common Area / Collaboration Space

Activity, flexibility, visibility, expanded classroom





Learning Corridors

Maximize utilization of all spaces





Learning Corridors

Maximize utilization of all spaces





Furniture: Tables

Clustering, screening, shapes





Furniture: Tables

Reconfigurable, interaction, group work





Furniture: Seating

Comfort, configuration, versatility, height, floor surface, movement

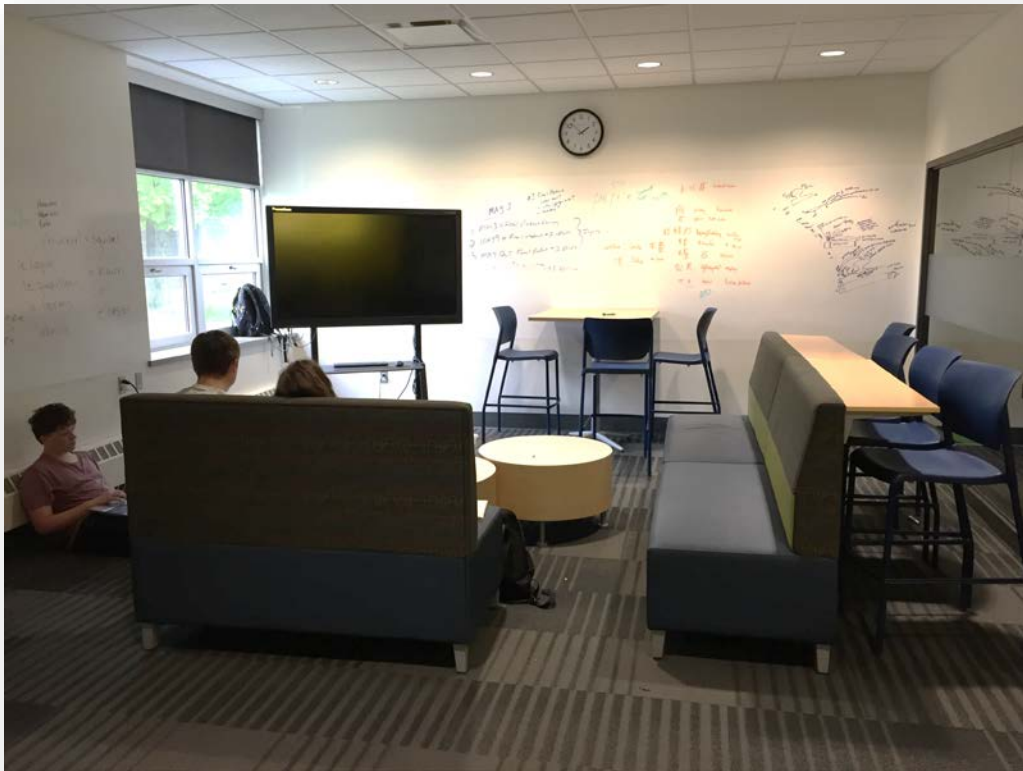



Technology

Shift from labs to portable/wireless, BYOD





Technology

Presentation, class engagement, power

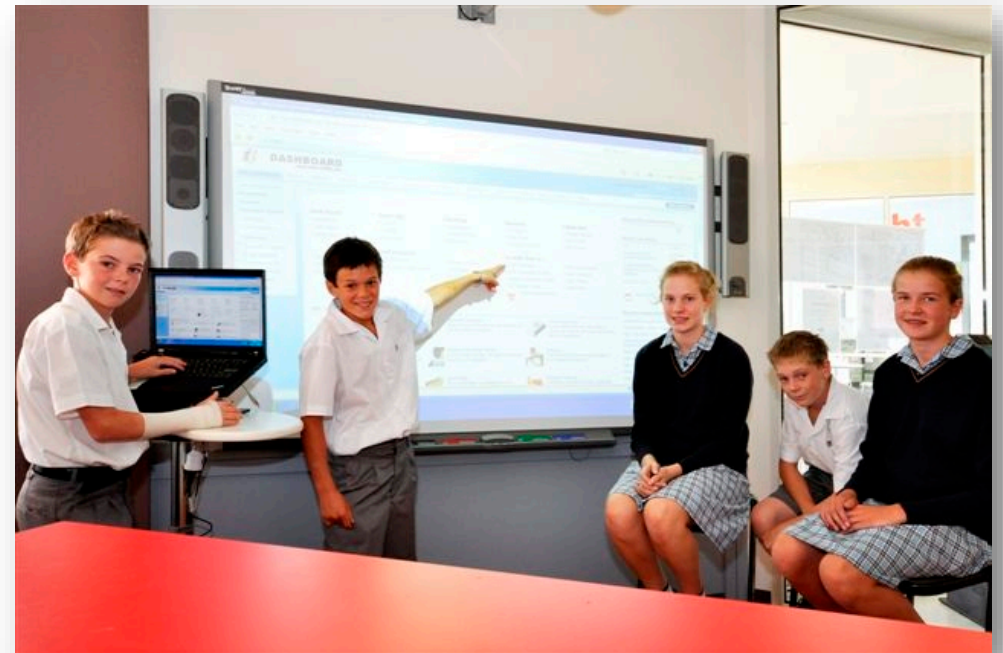



Walls: Folding Partitions / Barn Doors

Transparency, Openness, Use





Walls: Openness

Visual distraction, expansion of classroom



Walls: Enhanced Functionality

Integrated storage, writing / presentation surfaces



Walls: Storage

Integrated storage, writing / presentation surfaces



Acoustics

Individual / Group Privacy, Sound Control, Surfaces



Lighting

Daylight, Glare

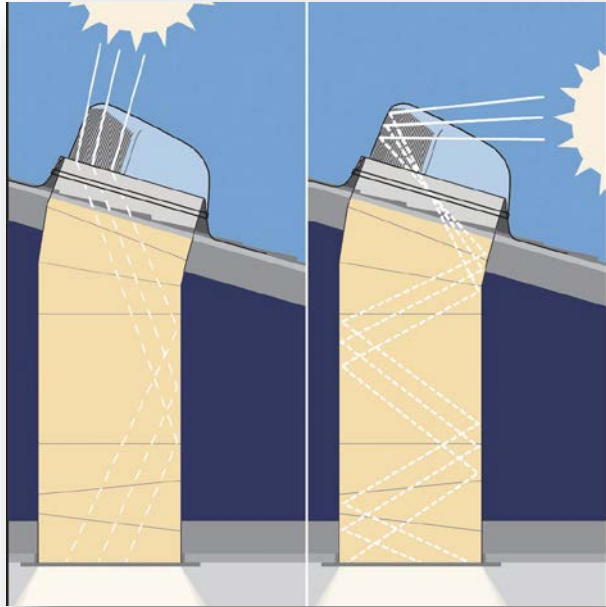



Remodeling for Personalized Learning

- Judicious removal of walls
- Enlarging / combining existing classrooms
- Replace with:
 - Drywall
 - Glass
 - Movable walls
 - No walls





Remodeling for Personalized Learning

- Storage
 - Consider removing most storage from classroom areas
 - Create shared storage space in close proximity to classrooms
 - If storage is in the classroom, look to create multipurpose functionality (i.e. writing surfaces or tack surfaces on face)
- Movable storage units
- Consider high density storage
- Eliminate countertops

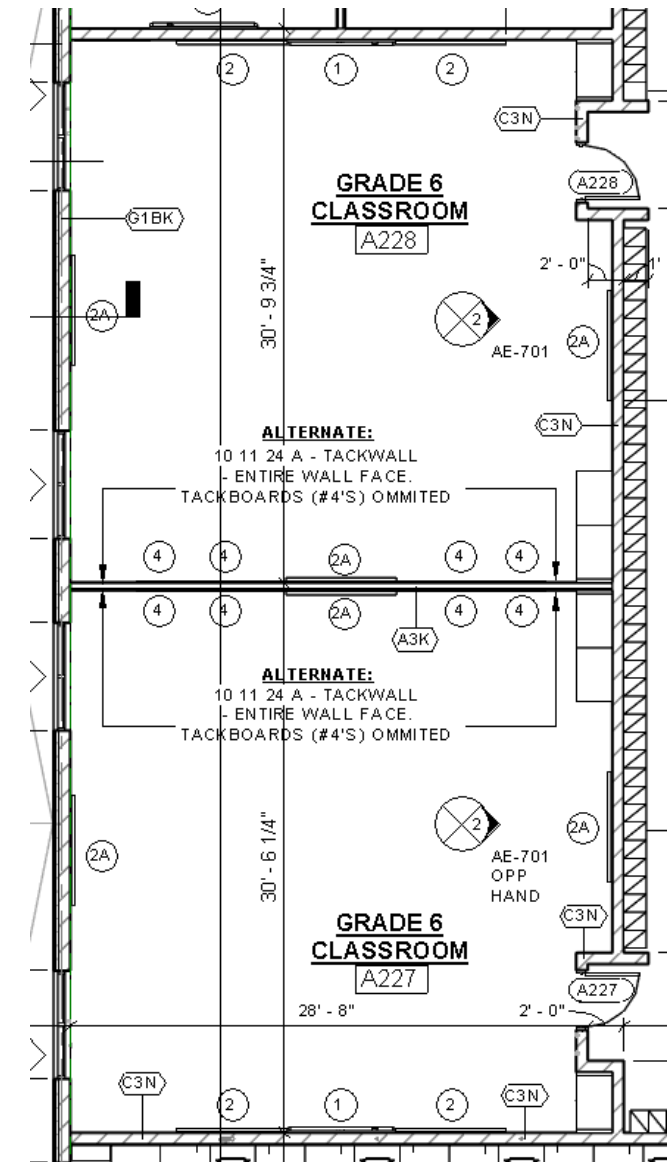



Remodeling for Personalized Learning

- Walls
 - Free up wall space
 - Avoid overuse of built-in casework
 - Strategically use full height casework to create learning areas
 - Functionality
 - Tackable
 - Writeable
 - Video display
 - Vision (supervision)
 - Height
 - Area expansion/division
 - Consider ability of students to divide into groups and have wall space to utilize
 - Wall construction





Remodeling for Personalized Learning

- Physical Characteristics
 - Acoustics
 - Ceiling heights
 - Baffles
 - Furniture
 - Floor/Wall treatments
 - White noise
 - Strategic sound transmission reduction
 - Lighting
 - Daylight
 - Direct/Indirect
 - Task
 - Glare
 - Temperature





Remodeling for Personalized Learning

- Student Learning
 - Types of Interaction
 - Watering Hole
 - Mountain Top
 - Sandpit
 - Cave
 - Campfire
 - Varied floor surfaces & heights
 - Break out zones
 - Eliminate clutter
 - Learning corridors
 - Varied seating heights / styles

